

ADAMS

RANGE 4

TOWNSHIP 2

KNOX TWP

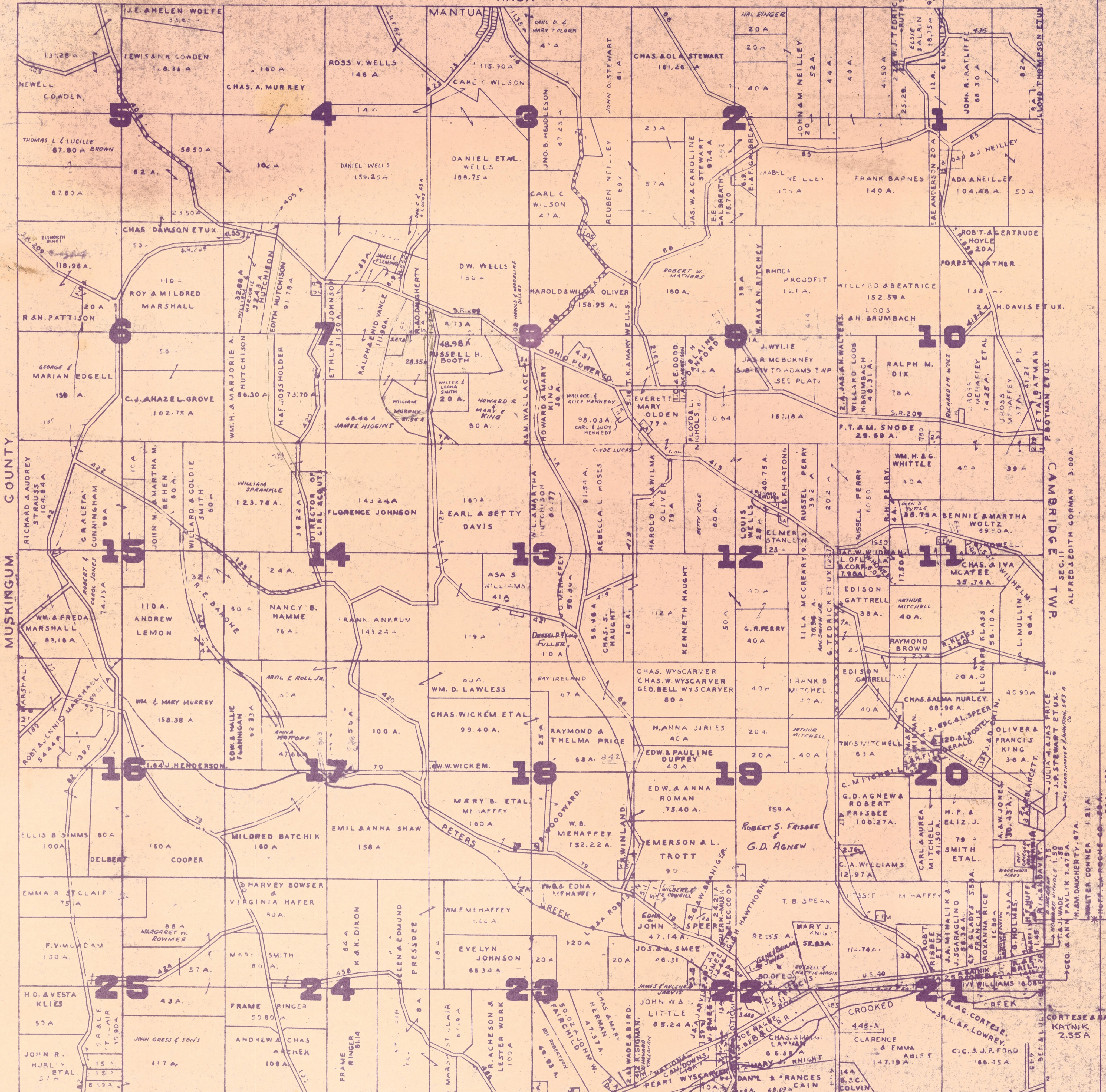

SEC. 12
J. R. & C. GOODWIN 0.77A.
B. & M. MORRISON 0.75A.
HARRY & M. LACEY 1.00A.
GARY STANLEY ETUX. 1.00A.
THOMAS S. SMITH & COLLETT 1.70A.
JAMES A. AMBRUSTER 1.07A.

*SEC. 21:
HOFFMAN-LAROCHE CO. .59A
W. E. G. CONNER .78A & .75A
W. K. E. MILLER .47A
STEVE E. M. ROLASCAR 2.62A
ARTHUR & M. GIBSON .60A & .50A

SEC. 22
PAUL LITTLE ETUX. 0.345
ROGER SIGMAN . . . 0.42A.
BOYD & CAMES 0.288
PAUL & CHAS. LITTLE 3.83A.
PAUL LITTLE JR. ETUX. 0.115+ .115A.
JOE HAGUE 1.50

SEC. 21
STUCKEYS INC. 2.00A.
A. J. & MABEL NICHOLS 1.00A.
80A.

SEC. 22
BOARD OF EDUCATION 8.83A.
JOHN KING MUSSIO 1.79A.

SEC. 21
HAROLD P. HUFF 1.50A.
PAUL J. HINGHAM 1.50A.
J. R. FULTON ETUX. 0.25A.
GILBERT ABLES ETUX. .4A

SEC. 11
ALFRED GORMAN ETUX. 100

SEC. 18
CHAS. & FRED A. SMITH 0.88A.

SEC. 20
ROY A. PONTELLO 1.00
LEWIS GAUDER ETUX. .87
RUSSELL S. EGRIED . . . 1.80
W. A. ANDERSON . . . 1.20+ .37A
GURNEY SUMNER & LOAN .49
THOS. D. GOLDEN .851
L. & F. AMBRUSTER 7A

ADAMS